

1. If campus portal gives you this message:

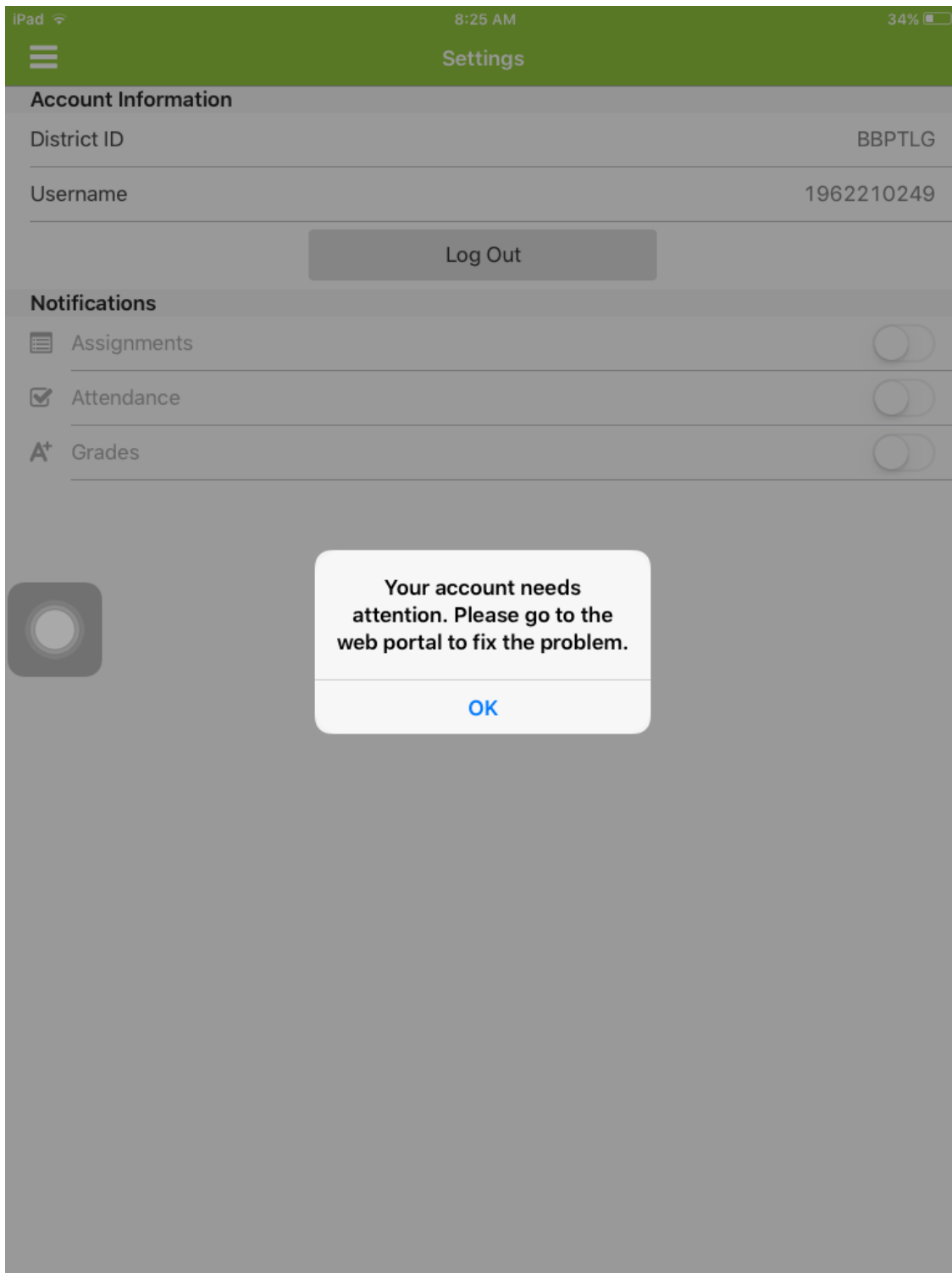

2. Click on Safari and go to the middle school webpage:

www.hancock.kyschools.us/2/Home

and click on the **IC** link.

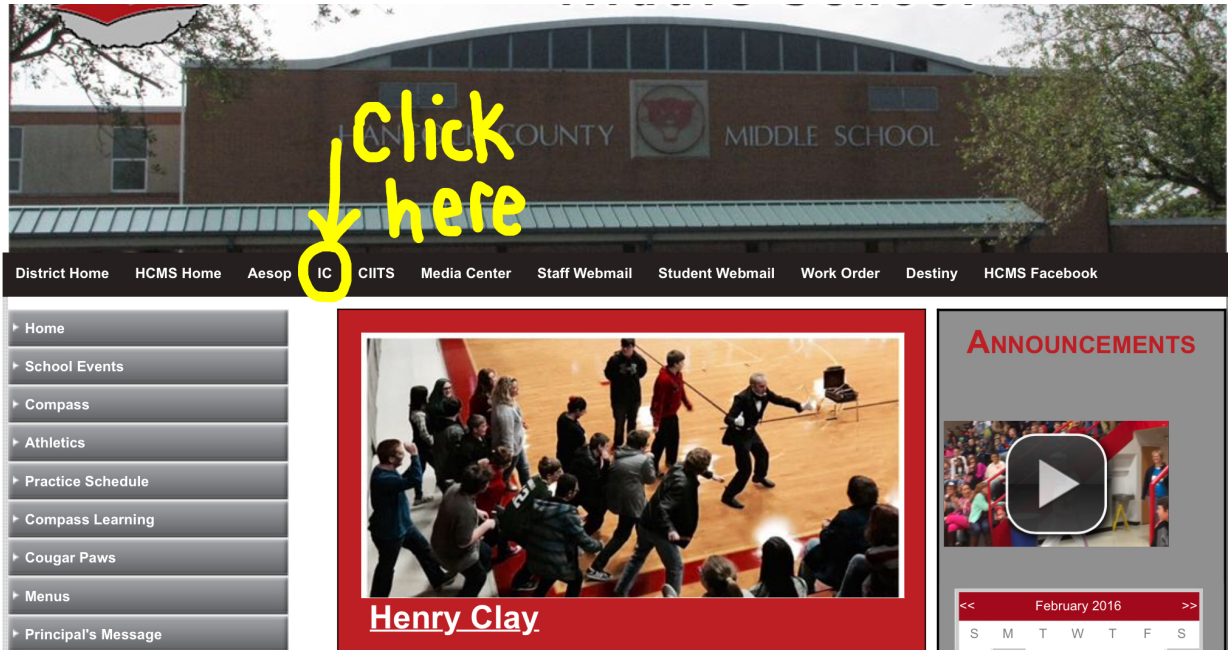

The image shows a screenshot of the Hancock County Middle School website. At the top, there is a banner image of the school building with the text "HANCOCK COUNTY MIDDLE SCHOOL". Below the banner is a navigation bar with several links: "District Home", "HCMS Home", "Aesop", "IC", "CIITS", "Media Center", "Staff Webmail", "Student Webmail", "Work Order", "Destiny", and "HCMS Facebook". A yellow arrow points to the "IC" link, with the text "Click here" written in yellow above it. Below the navigation bar is a sidebar with a list of links: "Home", "School Events", "Compass", "Athletics", "Practice Schedule", "Compass Learning", "Cougar Paws", "Menus", and "Principal's Message". The main content area features a large red-bordered image of a group of students performing on a stage, with the text "Henry Clay" written below it. To the right of the main content area is an "ANNOUNCEMENTS" section with a video player and a calendar for February 2016.

3. Infinite Campus will open. Here you will type in your username and password.

Username: Student # (ILP)

Password: vs081368 (example)

Infinite Campus
Transforming K12 Education®

District Edition

Version: Campus.1549.3
Hancock Live

Username

Password

[Sign In >>](#)

[Trouble accessing your account? Contact your administrator.](#)

©2003-2016 Infinite Campus, Inc.
www.infinitecampus.com

4. When you type in the correct information – a unique code will come up (called a Captiva) that you will have to type in EXACTLY as it appears! It is CAP specific and there are NO spaces.

8:41 AM 33%

central.infinitecampus.kyschools.us

Hancock County Schools Hancock Live Login

Infinite Campus Transforming K12 Education

District Ed

Version: Campus.1
Hancock

Username

Password

F 4 j v e M q
In addition to entering your username and password, please enter the letters and numbers shown. Do not enter spaces. Letters shown are case sensitive.

[Sign In >>](#)

Trouble accessing your account? Contact your administrator.

©2003-2016 Infinite Campus, Inc.
www.infinitecampus.com

5. Once all information is entered correctly and you are logged in on the web browser – you should log out of the app and log back in. Do NOT allow push notifications from Campus Portal.